

Loop Nut

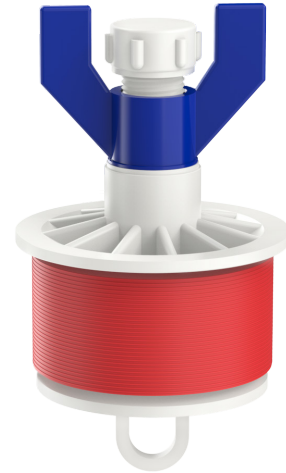

Inside Fit



Wing Nut

### PRODUCT COMPONENTS

The Kwikie™ Blank Duct plug is comprised of the following components: one stem, two O-rings, one bottom plate, one seal, one top plate, one washer, one nut (either loop or wing) and one cap

**NOTE:** Only blank duct plugs 2.5" | 65mm and bigger include one O-ring and cap

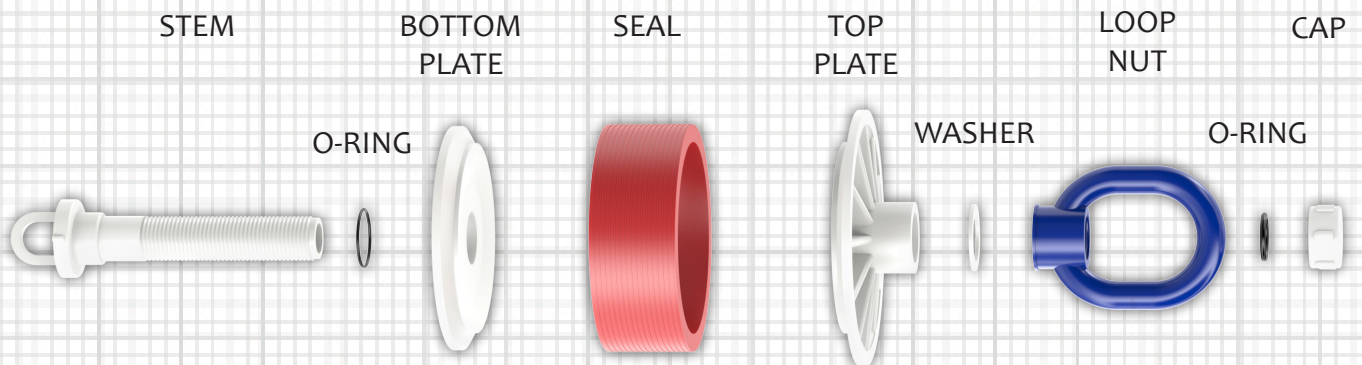

## INSTALLATION INSTRUCTIONS

- 1 For proper and secure installation, wipe the inside of the duct clean with a cloth prior to installing the plug.
- 2 If necessary, twist the nut (loop or wing) counterclockwise by hand to relieve any pressure in the seal prior to installing. Reference *Figure A*
- 3 Insert the plug so the top plate is fully seated on the end of the duct. If installing the Inside Fit plug, insert the plug as far inside the duct as you require. Reference *Figure B*.
- 4 Twist the nut (loop or wing) clockwise to expand the seal NOTE: Use a screwdriver through the loop nut if additional tightening is required. Reference *Figure C*.

NOTE: Kwikie™ blank duct plugs fit a range of duct sizes; tightness will vary dependent upon duct inner diameter within the plug ranges.



Figure A



Figure B

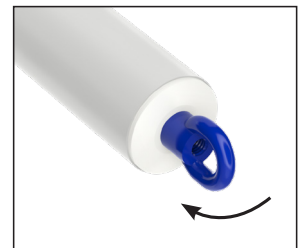
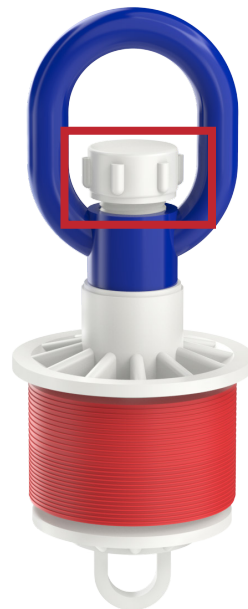

Figure C

Images above are based on the 2" | 50mm blank duct plug



2" | 50mm and smaller blank duct plugs are made with a solid stem so the cap is not required.



2.5" | 65 mm and larger blank duct plugs are made with a hollow stem so the cap and o-ring are required for a complete seal.