

## KEY FEATURES AND BENEFITS

- When the thermoplastic elastomer gasket is expanded, it creates a water, air, and rodent-resistant seal – protecting the conduit from damaging environmental conditions
- Constructed of non-metallic, corrosion-resistant materials for a long-lasting and cost-effective plug
- Requires no additional tools for quick and easy installation
- Install in PVC, HDPE, EMT, and corrugated conduit for versatility
- Two rope-tie points built into the plug for installation with mule tape or pull line for a secure seal

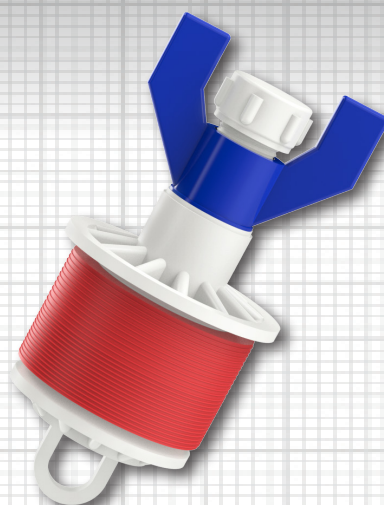

Loop Nut



Wing Nut

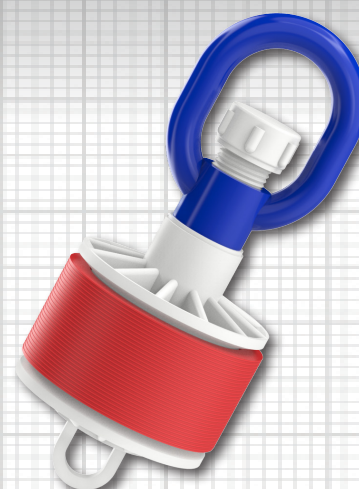

Inside Fit

**Kwikie**<sup>™</sup>  
Blank Duct Plugs

## Three styles to effectively seal a variety of blank conduit

The #1 trusted brand in blank duct plugs, the Kwikie<sup>™</sup> is essential to any datacenter, telecom, or underground electrical project. This is because the proper sealing of conduits and innerduct is vital for protecting infrastructure investment and, in many cases, required by code. After decades of use in the field by telecom and electrical professionals, the Kwikie has become an indispensable industry standard, and its usage continues to grow worldwide.

The plugs install tightly into conduit, creating a secure seal from unwanted water, sediment, or animal intrusion. A variety of sizes are available for various conduit dimensions and types, as they are compatible with HDPE, PVC, corrugated conduit, and EMT. Installation of the plugs is quick and easy, with no tools required for installation or removal.

There are three styles of Kwikie plugs available:

- Loop Nut – An additional tie point making the plug installable from both sides of the conduit
- Wing Nut – Smaller in height than the loop nut, allowing installation in tighter spaces
- Inside Fit – Can be installed entirely inside the conduit and out of sight from the outside; available in either loop nut or wing nut

While there are other methods of sealing conduit, they are costly, unprofessional, and time-consuming. For the highest quality and performance, the Kwikie is the top choice for datacenters that demand the best in blank duct plugs.

Visit [CalAm.net](https://calam.net)

<https://calam.net/electrical-broadband/mechanical-plugs/>

## SPECIFICATIONS

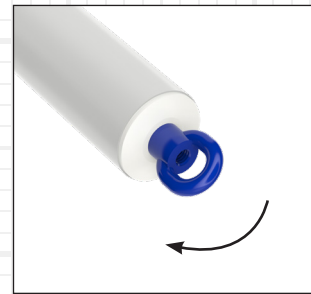
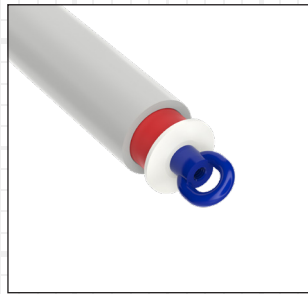
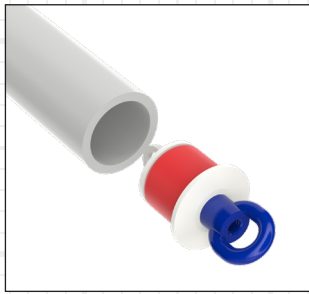

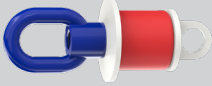
PRODUCT NUMBER	JACKMOON® CROSS REFERENCE NUMBER	EACH SIZE (mm)	UNIT OF MEASURE	CASE QUANTITY	CONDUIT INNER DIAMETER (mm)
 <b>LOOP NUT</b>					
5120-07	JM-BLA-07D100U	20	Case	50	19.46 - 25.91
5120-10	JM-BLA-10D104U	25	Case	50	25.25 - 35.31
5120-12	JM-BLA-12D148U	32	Case	50	29.36 - 38.35
5120-15	JM-BLA-15D183U	40	Case	50	37.08 - 46.48
5120-20	JM-BLA-20D236U	50	Case	50	46.58 - 60.60
5120-25L	JM-BLA-25D296U	65	Case	30	60.96 - 75.95
5120-30L	JM-BLA-30D346U	80	Case	30	74.17 - 87.63
5120-35L	JM-BLA-35D400U	90	Case	30	86.61 - 99.06
5120-40L	JM-BLA-40D402U	100	Case	30	100.08 - 109.98
5120-50L	JM-BLA-50D535U	125	Case	20	123.19 - 133.35
5120-58L	JM-BLA-50D500U	125	Case	20	118.75 - 133.35
5120-60L	JM-BLA-60D637U	150	Case	20	150.37 - 161.93
5120-80L	JM-BLA-80D816U	200	Case	12	198.37 - 209.55

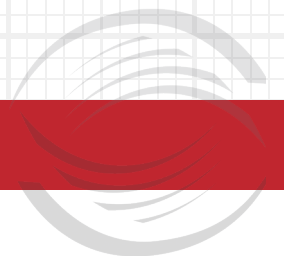

## SPECIFICATIONS

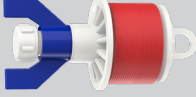
PRODUCT NUMBER	JACKMOON® CROSS REFERENCE NUMBER	EACH SIZE (mm)	UNIT OF MEASURE	CASE QUANTITY	CONDUIT INNER DIAMETER (mm)
 <b>WING NUT</b>					
5120-25	JM-BLA-25D296U	65	Case	30	60.96 - 75.95
5120-30	JM-BLA-30D346U	80	Case	30	74.17 - 87.63
5120-35	JM-BLA-35D400U	90	Case	30	86.61 - 99.06
5120-40	JM-BLA-40D402U	100	Case	30	100.08 - 109.98
5120-50	JM-BLA-50D535U	125	Case	20	123.19 - 133.35
5120-58*	JM-BLA-50D500U	125	Case	20	118.75 - 133.35
5120-60	JM-BLA-60D637U	150	Case	20	150.37 - 161.93
5120-80	JM-BLA-80D816U	200	Case	12	198.37 - 209.55

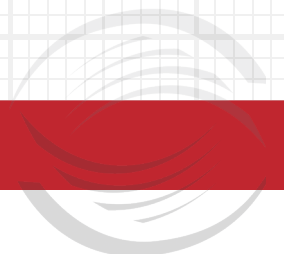

## SPECIFICATIONS

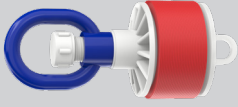
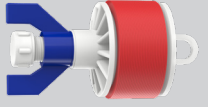
PRODUCT NUMBER	TYPE	EACH SIZE (mm)	UNIT OF MEASURE	CASE QUANTITY	CONDUIT INNER DIAMETER (mm)	
		<b>INSIDE FIT - LOOP NUT OR WING NUT</b>				
5120-15P	LOOP NUT	40	Case	50	37.08 - 46.48	
5120-20P	LOOP NUT	50	Case	50	46.58 - 60.60	
5120-30PL	LOOP NUT	80	Case	30	74.17 - 87.63	
5120-30P	WING NUT	80	Case	30	74.17 - 87.63	
5120-40PL	LOOP NUT	100	Case	30	100.08 - 109.98	
5120-40P	WING NUT	100	Case	30	100.08 - 109.98	
5120-50PL	LOOP NUT	125	Case	20	123.19 - 133.35	
5120-50P	WING NUT	125	Case	20	123.19 - 133.35	
5120-60PL	LOOP NUT	150	Case	20	150.37 - 161.93	
5120-60P	WING NUT	150	Case	20	150.37 - 161.93	



Picture to the left is an example of using the Blank Duct Plug, Inside Fit with Loop Nut.

For more technical information and/or to download the Tech Sheet for these products, please visit the Product Webpage: <https://calam.net/electrical-broadband/mechanical-plugs/>

Visit CalAm.net  
<https://calam.net/electrical-broadband/mechanical-plugs/>

## APPLICABLE CONDUIT

Look up the corresponding Kwikie™ plug per conduit type in the table below.

NOTE: Empty boxes indicate that the conduit is not made in that dimension.

PRODUCT NUMBER	CONDUIT SIZE	SCH40	SCH80	DB60	DB100	DB120	EMT	SDR9	SDR11	SDR13.5	SDR15.5	SDR17
Not available	12.7mm	X	X				X			X		
5120-07	19.1mm	✓	X				✓		✓	✓	✓	
5120-10	25.4mm	✓	*5120-07			✓	✓	✓	✓	✓	✓	✓
5120-12	31.8mm	✓	✓				✓	✓	✓	✓	✓	✓
5120-15	38.1mm	✓	✓			✓	✓	*5120-12	✓	✓	✓	
5120-20	50.8mm	✓	✓	✓		✓	✓	*5120-15	✓	✓	✓	
5120-25L	63.5mm	✓	*5120-20				✓					
5120-30L	76.2mm	✓	*5120-25L	✓	✓	✓	✓	*5120-25L	*5120-25L	✓	✓	
5120-35L	88.9mm	✓	*5120-30L				✓					
5120-40L	101.6mm	✓	*5120-35L	✓	✓	✓	✓	*5120-35L	*5120-35L	*5120-35L	*5120-35L	
5120-50L	127mm	✓	*5120-58L	X	✓	✓						
5120-58L	127mm	✓	✓	✓	✓	✓					✓	
5120-60L	152.4mm	✓	X	✓	✓	✓						
5120-80L	203.2mm	✓										

\* Cal Am product size required is different than trade size of conduit.

Applicable conduit types based on product's expansion range meeting or exceeding conduit average ID dimensions specified in one or more of following standards: UL651, UL651A, ASTM F2160, NEMA TC 6 & 8

### ABOUT CAL AM MANUFACTURING

Cal Am Manufacturing® specializes in products for use in underground electrical and broadband applications. Founded in Southern California over thirty-five years ago, Cal Am designs and produces fittings and sealing devices to serve utilities, municipalities, government facilities, data centers, and fiber optic projects, through a worldwide network of distributors.

### TEST OUR PRODUCT

Learn more at: <https://calam.net/test-our-products>

Corporate Office:  
El Cajon, CA 92020

Phone +1.619.336.9550  
Fax +1.619.336.9549

sales@calam.net  
marketing@calam.net  
accounting@calam.net

[www.CalAm.net](http://www.CalAm.net)