

## KEY FEATURES AND BENEFITS

- When the thermoplastic elastomer gasket is expanded, it creates a water and air-resistant seal - protecting datacenters from damaging environmental issues
- Constructed entirely of non-metallic, corrosion-resistant material, these plugs are long-lasting and cost-effective
- Designed to split apart for easy retrofit around in-place cables

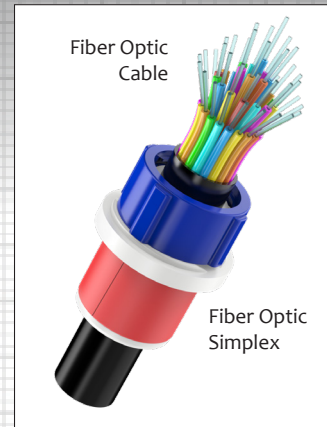
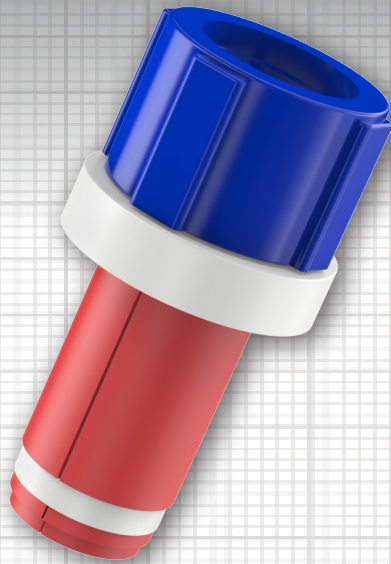

**JackMoon**<sup>®</sup>  
Sealing Devices

### Part of the Cal Am system, a fully comprehensive datacenter solution for securing fiber optic cable

A tried-and-true design, JackMoon<sup>®</sup> Fiber Optic Simplex plugs effectively organize and seal conduit containing one cable. Essential to any fiber optic network, they ensure cables are properly terminated and protected. Various sizes accommodate different conduit diameters and fiber sizes, making them suitable for multiple applications, including telecommunications, datacenters, internet utility, and power.

These plugs feature an expandable gasket that conforms to and contracts around the cable preventing the incursion of water, air, and dust into the duct system or building. They are made of non-metallic materials to prevent corrosion. The design is “plug-and-play” so that they can be easily installed without special tools or equipment. These benefits make Fiber Optic Simplex plugs a more professional solution than messy sealing foam or other solutions that can be easily removed and can cause unseen damage when installed.

JackMoon Fiber Optic Simplex plugs can be used with many types of fiber:

- Single-Mode Fiber (SMF)
- Multi-Mode Fiber (MMF)
- Common sizes such as 250 microns ( $\mu\text{m}$ ) (also known as 62.5/125 or 50/125 micron multimode fiber)

NOTE: the fiber optic simplex plugs should be selected based on the cable's outside diameter

These Fiber Optic Simplex plugs are a signature part of the Cal Am System: a fully comprehensive datacenter solution for sealing conduit, microduct, innerduct, and fiber optic cable. Whether building a new network or upgrading an existing one, the complete Cal Am System is the answer.

Visit [CalAm.net](https://calam.net)

<https://calam.net/electrical-broadband/fiber-optic-simplex-duct-plugs/>

## SPECIFICATIONS

PRODUCT NUMBER	JACKMOON® CROSS REFERENCE NUMBER	EACH SIZE (IN)	EACH SIZE (mm)	CONDUIT INNER DIAMETER (IN)	CONDUIT INNER DIAMETER (mm)	PORT DIAMETER RANGE (IN)	PORT DIAMETER RANGE (mm)
7110-027-035	N/A	1.00	25	1.05 - 1.13	26.67 - 28.70	0.27 - 0.35	6.86 - 8.89
7110-035-057	JM-SIM-10S057SB*	1.00	25	1.05 - 1.13	26.67 - 28.70	0.35 - 0.57	8.89 - 14.48
7110-051-071	JM-SIM-10S070SB*	1.00	25	1.05 - 1.13	26.67 - 28.70	0.51 - 0.71	12.95 - 18.03
7111-020-035	JM-SIM-11S035SB*	1.10	25	1.13 - 1.23	28.70 - 31.24	0.20 - 0.35	5.08 - 8.89
7111-035-057	JM-SIM-11S057SB*	1.10	25	1.13 - 1.23	28.70 - 31.24	0.35 - 0.57	8.89 - 14.48
7111-051-071	JM-SIM-11S070SB*	1.10	25	1.13 - 1.23	28.70 - 31.24	0.51 - 0.71	12.95 - 18.03
7112-035-057	JM-SIM-12S057SB*	1.25	32	1.28 - 1.36	32.51 - 34.54	0.35 - 0.57	8.89 - 14.48
7112-051-071	JM-SIM-12S070SB*	1.25	32	1.28 - 1.36	32.51 - 34.54	0.51 - 0.71	12.95 - 18.03
7112-071-090	JM-SIM-12S090SB	1.25	32	1.22 - 1.36	30.98 - 34.54	0.71 - 0.90	18.03 - 22.86
7113-012-043	JM-SIM-13S043SB*	1.375	35	1.40 - 1.50	35.56 - 38.10	0.12 - 0.43	3.05 - 10.92
7113-035-057	JM-SIM-13S057SB*	1.375	35	1.40 - 1.50	35.56 - 38.10	0.35 - 0.57	8.89 - 14.48
7113-051-071	JM-SIM-13S070SB*	1.375	35	1.40 - 1.50	35.56 - 38.10	0.51 - 0.71	12.95 - 18.03
7115-008-035	JM-SIM-15S035SB*	1.50	40	1.46 - 1.56	37.08 - 39.62	0.08 - 0.35	2.03 - 8.89
7115-035-057	JM-SIM-15S057SB*	1.50	40	1.46 - 1.56	37.08 - 39.62	0.35 - 0.57	8.89 - 14.48
7115-051-071	JM-SIM-15S070SB*	1.50	40	1.46 - 1.56	37.08 - 39.62	0.51 - 0.71	12.95 - 18.03
7116-051-071	JM-SIM-15S070AB*	1.60	41	1.56 - 1.70	39.62 - 43.18	0.51 - 0.71	12.95 - 18.03
7116-071-090	JM-SIM-15S090SB*	1.60	41	1.56 - 1.70	39.62 - 43.18	0.71 - 0.90	18.03 - 22.86
7120-008-014	JM-SIM-20S020SB*	2.00	50	1.92 - 2.06	48.77 - 52.32	0.08 - 0.14	2.03 - 3.56
7120-015-024	JM-SIM-20S020SB*	2.00	50	1.92 - 2.06	48.77 - 52.32	0.15 - 0.24	3.81 - 6.10
7120-025-051	JM-SIM-20S043SB*	2.00	50	1.92 - 2.06	48.77 - 52.32	0.25 - 0.51	6.35 - 12.95
7120-052-075	JM-SIM-20S070SB*	2.00	50	1.92 - 2.06	48.77 - 52.32	0.52 - 0.75	13.21 - 19.05
7120-076-100	N/A	2.00	50	1.92 - 2.06	48.77 - 52.32	0.76 - 1.06	19.30 - 26.92
7120-090-110	JM-SIM-20S110SB	2.00	50	1.92 - 2.06	48.77 - 52.32	0.81 - 1.12	20.57 - 28.45

\*Please call Cal Am for confirmation on port sizing for JackMoon cross reference products.

Visit [CalAm.net](https://calam.net)  
<https://calam.net/electrical-broadband/fiber-optic-simplex-duct-plugs/>

Cal Am Manufacturing is a registered trademark of Stratus Manufacturing, Inc.  
 © 2023 All Rights Reserved. Cal Am Manufacturing, El Cajon, CA 92020

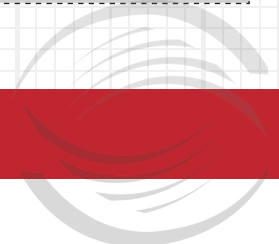

## SPECIFICATIONS

PRODUCT NUMBER	UNIT OF MEASURE	CASE QUANTITY	CASE DIMENSIONS (IN)	CASE DIMENSIONS (cm)	CASE WEIGHT (lbs)	CASE WEIGHT (kg)
7110-027-035	CASE	20	4 x 7 x 10	10.2 x 17.8 x 25.4	3	1.36
7110-035-057	CASE	20	4 x 7 x 10	10.2 x 17.8 x 25.4	3	1.36
7110-051-071	CASE	20	4 x 7 x 10	10.2 x 17.8 x 25.4	3	1.36
7111-020-035	CASE	20	4 x 7 x 10	10.2 x 17.8 x 25.4	3	1.36
7111-035-057	CASE	20	4 x 7 x 10	10.2 x 17.8 x 25.4	3	1.36
7111-051-071	CASE	20	4 x 7 x 10	10.2 x 17.8 x 25.4	3	1.36
7112-035-057	CASE	20	4 x 9 x 11	10.2 x 22.9 x 27.9	4	1.81
7112-051-071	CASE	20	4 x 9 x 11	10.2 x 22.9 x 27.9	4	1.81
7112-071-090	CASE	20	4 x 9 x 11	10.2 x 22.9 x 27.9	4	1.81
7113-012-043	CASE	20	4 x 9 x 11	10.2 x 22.9 x 27.9	4	1.81
7113-035-057	CASE	20	4 x 9 x 11	10.2 x 22.9 x 27.9	4	1.81
7113-051-071	CASE	20	4 x 9 x 11	10.2 x 22.9 x 27.9	4	1.81
7115-008-035	CASE	20	4 x 9 x 12	10.2 x 22.9 x 30.5	4	1.81
7115-035-057	CASE	20	4 x 9 x 12	10.2 x 22.9 x 30.5	4	1.81
7115-051-071	CASE	20	4 x 9 x 12	10.2 x 22.9 x 30.5	4	1.81
7116-051-071	CASE	20	4 x 9 x 12	10.2 x 22.9 x 30.5	4	1.81
7116-071-090	CASE	20	4 x 9 x 12	10.2 x 22.9 x 30.5	4	1.81
7120-008-014	CASE	20	2.6 x 9.9 x 12.3	10.2 x 25.4 x 35.6	5	2.27
7120-015-024	CASE	20	2.6 x 9.9 x 12.3	10.2 x 25.4 x 35.6	5	2.27
7120-025-051	CASE	20	2.6 x 9.9 x 12.3	10.2 x 25.4 x 35.6	5	2.27
7120-052-075	CASE	20	2.6 x 9.9 x 12.3	10.2 x 25.4 x 35.6	5	2.27
7120-076-100	CASE	20	2.6 x 9.9 x 12.3	10.2 x 25.4 x 35.6	5	2.27
7120-090-110	CASE	20	3.25 x 9.5 x 11.5	8.3 x 24.1 x 29.2	5	2.27

### ABOUT CAL AM MANUFACTURING

Cal Am Manufacturing® specializes in products for use in underground electrical and broadband applications. Founded in Southern California over thirty-five (35) years ago, Cal Am designs and produces fittings and sealing devices to serve utilities, municipalities, government facilities, data centers, and fiber optic projects, through a worldwide network of distributors.

### TEST OUR PRODUCT

Learn more at: <https://calam.net/test-our-products>

Corporate Office:  
El Cajon, CA 92020

Phone +1.619.336.9550  
Fax +1.619.336.9549

[sales@calam.net](mailto:sales@calam.net)  
[marketing@calam.net](mailto:marketing@calam.net)  
[accounting@calam.net](mailto:accounting@calam.net)

[www.CalAm.net](http://www.CalAm.net)